

Install screws to this side of
Mounting Clip (Step 1)

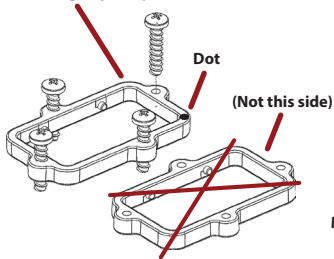

Mounting Clip Screws
(Step 4)

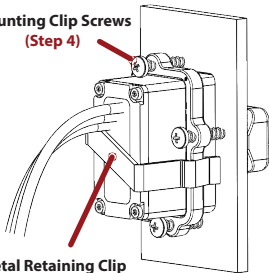

Metal Retaining Clip
(Step 3)

Wiring:
Black-Ground | Red-5.00vdc | White-Output Signal

**Caution: Be careful to not
overtighten the screws**

CTI-TW Thumbwheel Mounting Information

(Step 1) Install the (4) screws to the Mounting Clip's dot side.

(Step 2) Install the Thumbwheel through the plate.

(Step 3) Add Metal Retaining Clip.

(Step 4) Lightly tighten the screws.

**For additional information visit
www.cyber-tech.net/thumbwheels**

